

Max. 2A @ 16VDC
31-157-0 2.1mm
31-158-0 2.5mm
 Use -1 for Display Pkg.

**2.1mm DC POWER JACK
to TERMINAL BLOCK**



There is a 2.1mm DC jack on one end, and a screw terminal block on the other. The terminals are labeled with positive/negative, assuming a center positive configuration

31-170-0 Bulk
31-170-1 Pkg.

**2.1mm DC POWER PLUG
to TERMINAL BLOCK**



There is a 2.1mm DC plug on one end, and a screw terminal block on the other. The terminals are labeled with positive/negative, assuming a center positive configuration

31-171-0 Bulk
31-171-1 Pkg.

TEST JACKS & PLUGS

CHASSIS BANANA JACKS

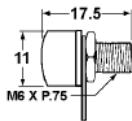

31-401-0 Black
31-400-2 Red and Black Pkg (2)
31-402-0 Red

CHASSIS BANANA JACKS

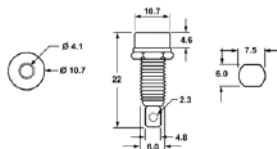

Multi-colored chassis mounting Banana jacks.

31-411-0 Black
31-414-0 Yellow
31-416-0 Blue
31-410-2 Red/Black
31-412-0 Red
31-415-0 Green
31-419-0 White
31-410-6 Asst. (6)

BINDING POSTS

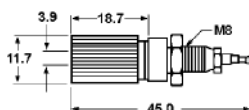

31-421-0 Black
31-420-2 Pkg (red & blk)
31-422-0 Red

LARGE BINDING POSTS

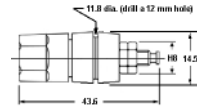

Gold plated. 15A @ 125V AC

31-441-0 Black
31-443-2 Pkg (red & blk)
31-442-0 Red

LOW PROFILE BINDING POSTS

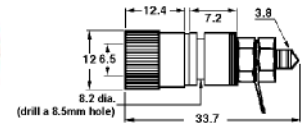

31-431-0 Black
31-430-2 Pkg 1 red 1 black
31-432-0 Red

DUAL BINDING POSTS

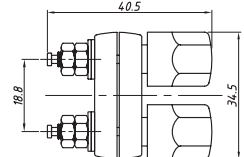

Gold plated
30A

31-440-0 Bulk
31-440-1 Pkg

BANANA PLUGS

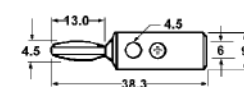

31-461-0 Black
31-460-2 Pkg 1 red 1 black
31-462-0 Red

COMPUTER ACCESSORIES

RS232 GENDER CHANGERS



Low profile gender changers with appropriate mounting hardware.

Use -1 for Display Package (except 32-025-0)

Positions	male-male	male-female	fem-fem
9-pos.	32-021-0	32-022-0	32-023-0
15-pos.			32-026-0
25-pos.			32-029-0

32-021HD-0 15-pos., high density, male-male
32-023HD-0 15-pos., high density, fem.-fem.

**MODULAR PHONE JACK TO RS232
ADAPTERS**



Note: RJ45(8C) types will accept RJ12(6C) plugs.
 RJ12 = 6P/6C
 RJ45 = 8P/8C

32-321-0 RJ45(8C) - 9-position male
32-322-0 RJ45(8C) - 9-position female
32-323-0 RJ45(8C) - 15-position male
32-325-0 RJ45(8C) - 25-position male

Use -1 for Display Package



60MHz SCOPE PROBE

1.5 meter length
Attenuation: 1x and 10x
Input Resistance: 1 M and 10 M ohms
Bandwidth: 6MHz(400V Peak to peak max.)
60MHz(600V peak to peak max.)
Compensation adjustment in BNC connector

33-010-1 Display Package



100MHz SCOPE PROBE

1.5 meter length
Attenuation: 1x and 10x
Input Resistance: 1 M and 10 M ohms
Bandwidth: 10MHz (300V peak to peak max.)
100MHz (600V peak to peak max.)
Compensation adjustment in BNC connector
Includes multi-accessory kit

33-015-0 Bulk
33-015-1 Display Package

METER REPLACEMENT LEAD



Set of red & black test leads with banana plugs. Plugs & probes are molded.

33-140-0 Set(bulk)
33-140-2 Package

CLIP LEAD SETS



24 AWG

Set of 10 18" clip leads with 31mm insulated clips. 24 AWG stranded wires. Colors: 2 red, 2 black, 2 green, 2 yellow, 2 white

33-210-0 Bulk set 10
33-210-10 Display Pkg

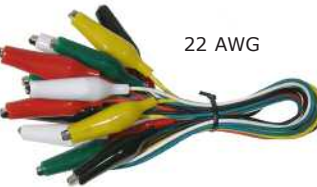

22 AWG

Set of 10 heavy duty 24" clip leads with 50mm clips. 5 different colors.

33-220-0 Bulk set 10
33-220-10 Display Pkg

NATURAL NYLON CABLE TIES



High quality nylon cable ties available in bags of 1000 or smaller quantity display packages. Made of UL approved Nylon 66, 94V-2

	Length	Width	Load
34-121-100	3.5" (90mm)	2.4mm	8 Kg
34-121-1000			
34-122-100	4" (100mm)	2.5mm	8 Kg
34-122-1000			
34-123-100	5.5" (140mm)	4.0mm	18Kg
34-123-1000			
34-124-100	7.5" (188mm)	4.8mm	22Kg
34-124-1000			
34-125-100	8" (200mm)	4.8mm	22Kg
34-125-1000			
34-126-50	11" (300mm)	4.8mm	22kg
34-126-1000			

Note: -1000 are bulk packages of 1,000. Others are Display Packages.

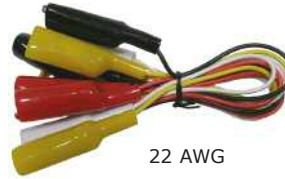

22 AWG

Set of 4 heavy duty 30" clip leads with 50mm clips. Colors: black, red, yellow, white.

33-230-0 Bulk set 4
33-230-4 Display Pkg

SEIZER PROBES (55mm)



33-361-0 Black
33-362-0 Red
33-360-2 Pkg
1 red 1 black

32mm ALLIGATOR CLIPS



33-400-0 Bulk
33-400-10 Pkg (10)

32mm INSULATED ALLIGATOR CLIPS



Note: The 33-409-0 contains 10 clips in 5 colors, the -10 is a display package of 10.

33-409-0 Bulk set 10
33-409-10 Pkg (10)

40mm INSULATED ALLIGATOR CLIPS



33-411-0 Bulk black
33-412-0 Bulk red
33-419-10 Pkg 5 red/black

51mm ALLIGATOR CLIPS (with screw)



33-430-0 Bulk
33-430-10 Pkg (10)

51mm INSULATED ALLIGATOR CLIPS



33-431-0 Bulk black
33-432-0 Bulk red
33-439-10 Pkg 5 red/black

NATURAL COLOR CABLE TIES



Colored, high quality nylon cable ties made of UL approved Nylon 66, 94V-2. Load: 8Kg

	Length	Width	Color
34-122BL-100	4" (100mm)	2.5mm	Blue
34-122BL-1000	4" (100mm)	2.5mm	Blue
34-122GN-100	4" (100mm)	2.5mm	Green
34-122GN-1000	4" (100mm)	2.5mm	Green
34-122RD-100	4" (100mm)	2.5mm	Red
34-122RD-1000	4" (100mm)	2.5mm	Red
34-122YL-100	4" (100mm)	2.5mm	Yellow
34-122YL-1000	4" (100mm)	2.5mm	Yellow